

## ASC1202C

### Two Door Access Controller



**ASC1202C**

### Features

- > Support 100,000 valid cards & 300,000 records
- > Support multiple cards
- > Support card, password, fingerprint unlock and combination
- > TCP/IP or RS-485 interface to PC
- > Wiegand or RS-485 interface to readers(1/2 door)
- > Door time out alarm, intrusion alarm, duress alarm and tamper alarm
- > Anti-pass back, multi-door interlock, multi-card open
- > Support 128 efficient time and holiday schedules
- > Watch dog function ensure device free from halting
- > Internal battery

# ASC1202C

## Technical Specifications

<b>Model</b>	<b>ASC1202C</b>
<b>System</b>	
Main Processor	32 Bit
Memory	16M(32M External)
<b>Input/Output Ports</b>	
Input	Inputs x 6 ( door sensor x 2, exit button x 2, alarm x 2)
Output	Relay x 4(door lock x 2, alarm x 2 )
Reader	Reader x 2
<b>Capacity</b>	
Cardholders/Events	100,000/150,000
<b>Function</b>	
User Management	General, VIP, Guest, Patrol, Black list, Force
Alarm Function	Door time out alarm, Intrusion alarm, Duress alarm, Tamper alarm
Schedule Setting	Support 128 groups of schedule, 128 groups of period and 128 groups of holiday period
<b>Interface</b>	
To PC	RJ45(10/100M)/RS485
To Reader	Wiegand/ RS485
<b>General</b>	
RTC	Yes
Power Supply	9-15DC/500mA
Working Environment	-30°C -+60°C
Working Humidity	≤95%
Dimension(W×D×H)	280*320*114mm
Weight	2Kg

# ASC1202C

## System Connection

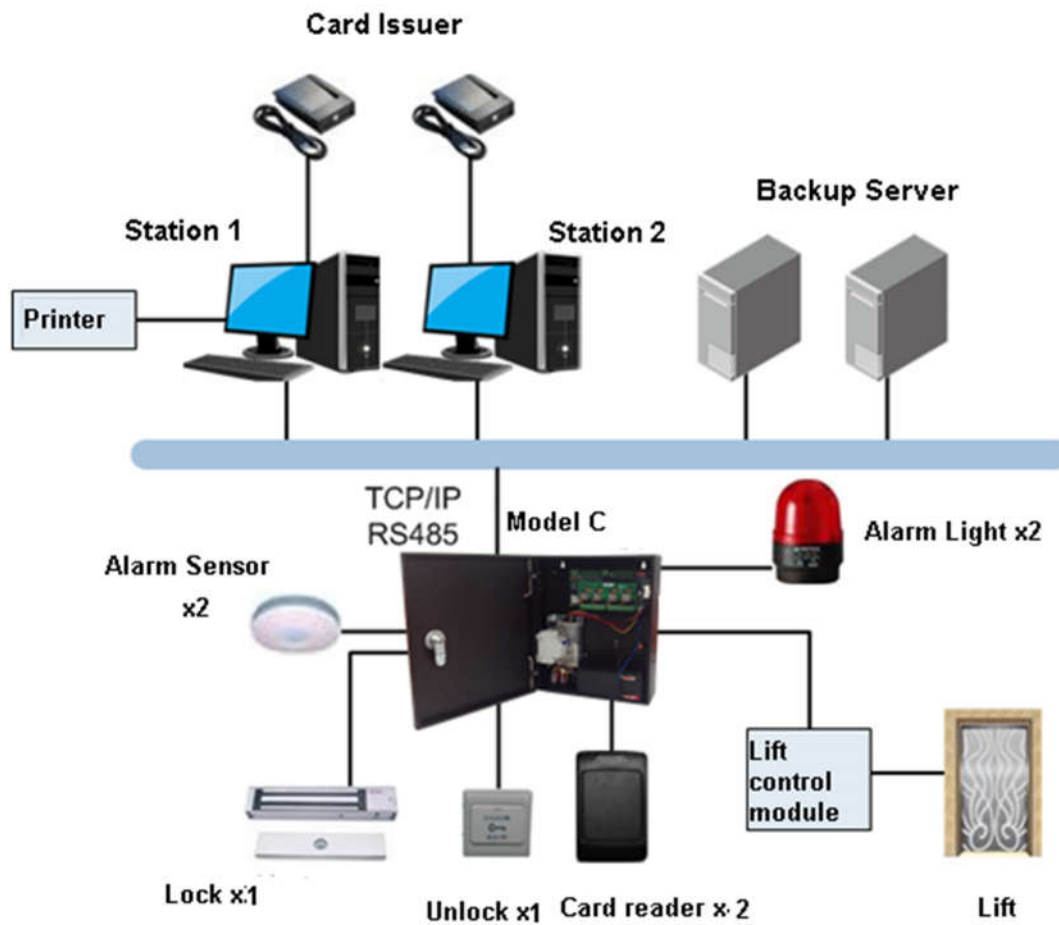

### Dahua Technology Co., Ltd.

1187 BinAn Road, Binjiang District, Hangzhou, China

Tel: +86-571-87688883

Fax: +86-571-87688815

Email: overseas@dahuatech.com

www.dahuatech.com

\*Design and specifications are subject to change without notice.

© 2015 Dahua Technology Co., Ltd.